

K PUSH WITH RAIL

Push system for opening doors without handles.

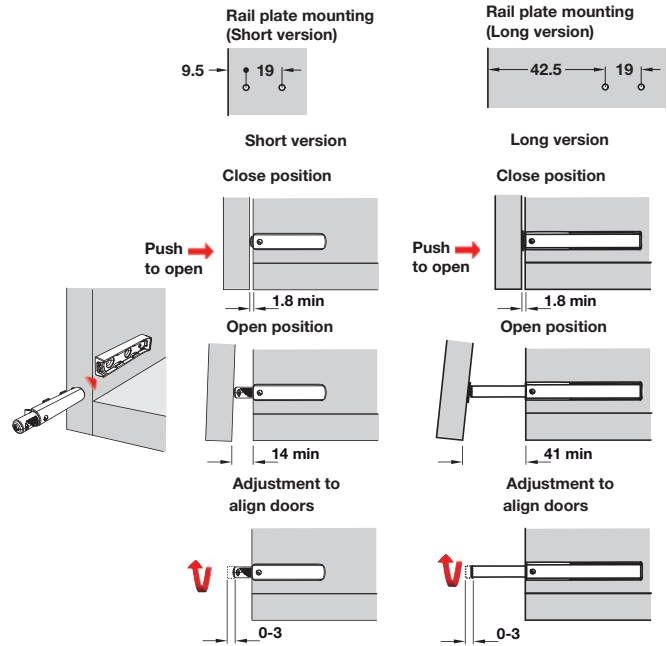

K Push and plate - short or long version

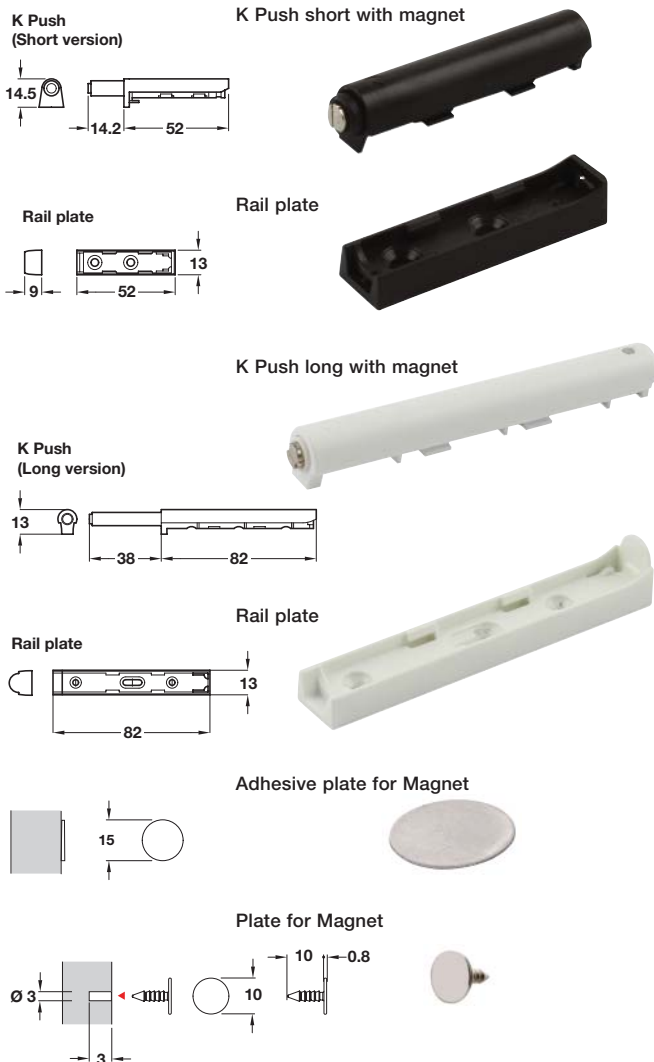

- > Available either with magnet or with buffer
With magnet for cabinets using unsprung hinges (order plate for magnet separately)
With buffer for cabinets using sprung hinges
- > Screw fixing rail plate with wood screws (screws not included)
- > K Push slides onto rail plate and clicks in
- > Important: Do not press or release the spring until the K Push is fully installed
- > Grey or black engineering plastic with magnet or rubber buffer
- > Order K Push and rail plate separately
- > Order qty: 1 pc



| K Push type | Grey | Black |
|-----------------------------------|------------|------------|
| K Push - short version | | |
| With buffer | 356.01.501 | 356.01.301 |
| With magnet | 356.01.511 | 356.01.311 |
| Rail plate | 356.01.519 | 356.01.319 |
| K Push - long version | | |
| With buffer | 356.01.502 | 356.01.302 |
| With magnet | 356.01.512 | 356.01.312 |
| Rail plate | 356.01.519 | 356.01.319 |
| Cat. No. | | |
| Adhesive plate for magnet | 356.01.539 | |
| Plate for magnet, with Ø 3 mm pin | 356.01.549 | |