



Latch version



Standard keyway version



Bathroom version

LAMONT lever on plate

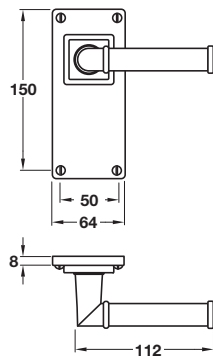

- > Pair of lever handles on backplates
- > Sprung, for use with standard duty followers
- > 8 mm spindle and face fixings included
- > To suit doors 35-44 mm thick
- > Standard keyway version 57 mm lock centres
- > Bathroom version 57 mm lock centres 5 mm square spindle included
- > Solid pewter
- > Order qty: 1 pc



	Latch	Standard keyway	Bathroom
Cat. No.	901.99.965	901.99.966	901.99.967

LAMONT lever handles with square rose

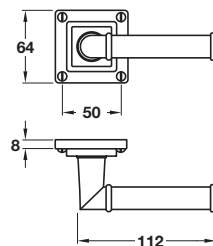

- > Pair of lever handles and roses
- > Sprung, for use with standard duty followers
- > Face fixing screws and 8 mm spindle included
- > To suit doors 35-44 mm thick
- > Solid pewter
- > Order qty: 1 pc



Lever handles with square rose	Cat. No.	900.20.149
--------------------------------	----------	------------



> Due to the manufacturing process of the handles shown on this page there may be a +/- 3 mm tolerance on non-critical dimensions and +/- 1 mm on hole centre dimensions