

Butt Hinges

High Specification Brass Hinges for the Cabinet Maker

A Heavy gauge butt hinge

- With brass pin
- Unwashed but with extra thick flaps
- Brass

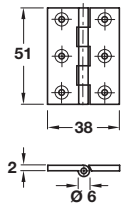

Length x width	51 x 38 mm
Self colour	354.10.532
Polished brass	354.10.830
Polished chrome	354.10.230
Satin chrome	354.10.432

Order qty: 1 pc

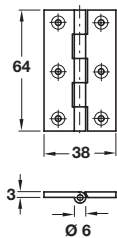

Length x width	64 x 38 mm
Self colour	354.10.540
Polished brass	354.10.840
Polished chrome	354.10.240

Order qty: Multiples of 20 pcs

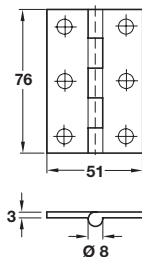

Length x width	76 x 51 mm
Self colour	921.08.408
Polished brass	921.08.430
Polished chrome	921.08.435

Order qty: 1 pc

B Finial butt hinge

- Threaded detachable steeple finial
- Unwashed
- Fixing screws included
- Brass

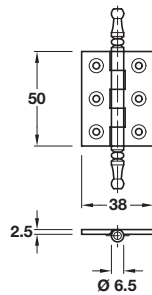

Length x width	50 x 38 mm
Satin nickel-plated	354.43.600
Antique bronze	354.43.100

Order qty: 1 pc

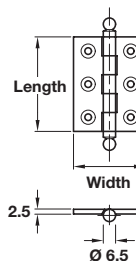

Length x width	50 x 38 mm
Satin nickel-plated	354.43.610
Polished brass	354.43.510
Polished chrome	354.43.210
Satin chrome	354.43.410
Length x width	63 x 35 mm
Polished chrome	354.43.211
Satin chrome	354.43.411

Order qty: 1 pc

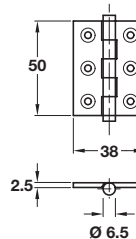

Length x width	50 x 38 mm
Polished brass	354.43.520
Antique bronze	354.43.120
Satin nickel	354.43.620
Polished chrome	354.43.220
Satin chrome	354.43.420

Order qty: 1 pc

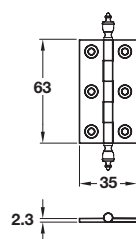

Length x width	63 x 35 mm
Polished chrome	354.43.231
Satin chrome	354.43.431

Order qty: 1 pc

C Cranked hinge

- Unhanded
- With brass pin
- Brass

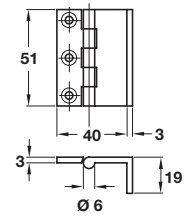

Finish	Cat. No.
Self colour	354.64.500

Order qty: 1 pc

D Table hinge

- With brass pin
- Polished brass

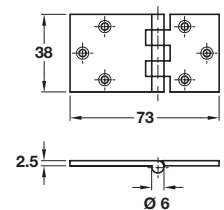

Length x width	38 x 73 mm
Cat. No.	354.28.802

Order qty: 1 pc

E Desk hinge

- With brass pin
- Electro brass

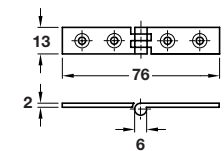

Length x width	13 x 76 mm
Self colour	354.41.001
Polished brass	354.41.801

Order qty: 1 pc

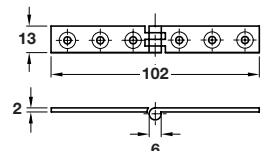
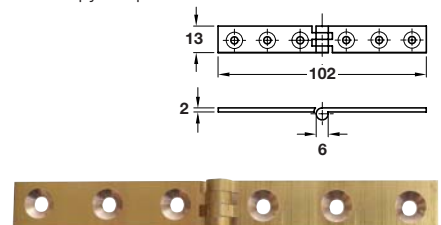

Length x width	13 x 102 mm
Self colour	354.41.002
Polished brass	354.41.802

Order qty: 1 pc