

- **Rafix 20 housings**, zinc alloy or plastic
- For $\varnothing 7$ mm connecting bolts, shown on pages 22-25
- For wood thicknesses from 16 and 19 mm
- Available with or without ridge
- **Rafix housings, standard and flush fitting** are shown on page 20
- **Rafix TAB housings** are shown on page 22

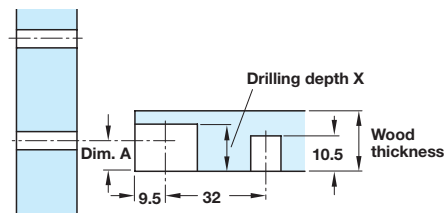

Drilling depth X = depending on housing type and wood thickness (see ordering table)

Dimension A = 1/2 wood thickness (see ordering table)

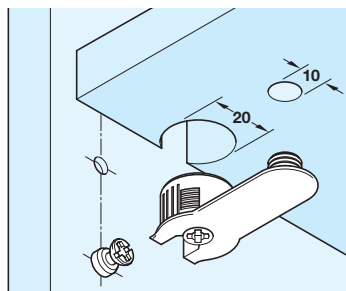

With ridge:
The horizontal panel can only be installed from above and the cabinet elements are pre-assembled

Without ridge:
The horizontal panel can be installed end-on or from above

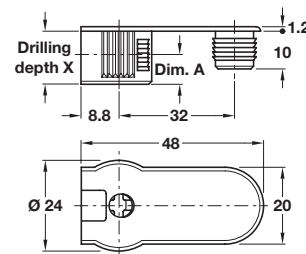

A Rafix-20 housing, zinc alloy

- **Zinc alloy** housing with zinc alloy tightening element
- For wood thickness from 16 or 19 mm

For wood thickness from	Dim. A	Drilling depth X	Cat. No. Nickel-plated				
Without ridge							
19 mm	9.5 mm	14.2 ^{+0.3} mm	263.13.705				
With ridge							
16 mm	8.0 mm	12.7 ^{+0.3} mm	263.17.703				
19 mm	9.5 mm	14.2 ^{+0.3} mm	263.17.705				

Order qty: 100 pcs

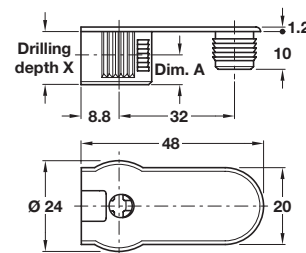

B Rafix-20 housing, plastic

- **Plastic** housing with zinc alloy tightening element
- For wood thickness from 16 or 19 mm

For wood thickness from	Dim. A	Drilling depth X	Cat. No.				
			White	Silver coloured	Black	Beige	Brown
Without ridge							
16 mm	8.0 mm	12.7 ^{+0.3} mm	263.12.703	263.12.203	263.12.303	263.12.403	-
19 mm	9.5 mm	14.2 ^{+0.3} mm	263.12.705	-	263.12.305	263.12.405	263.12.105
With ridge							
16 mm	8.0 mm	12.7 ^{+0.3} mm	263.16.703	-	-	-	-
19 mm	9.5 mm	14.2 ^{+0.3} mm	263.16.705	-	-	-	-

Order qty: Multiples of 100 pcs