

StarTec VIVA straight lever handles

- Pair of lever handles and roses
- 8 mm spindle included
- Sprung, for use with standard duty followers
- Bolt through fixings included
- To suit doors **35-44 mm** thick
- Polished chrome zinc alloy and satin stainless steel

Finish	Cat. No.
Polished/satin	900.21.742

Order qty: 1 pair

StarTec VIVA accessories

- **Escutcheons:** Fixings included
- **WC release and inside turn**
To suit doors **35-44 mm** thick
5 mm spindle and fixings included
- Polished chrome zinc alloy and satin stainless steel

Finish	Polished/satin
Standard keyway escutcheon	
Cat. No.	902.51.057
Euro profile cylinder escutcheon	
Cat. No.	902.52.057
WC release and inside turn*	
Cat. No.	902.53.057

Order qty: 1 pair (*set)

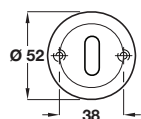

Standard keyway escutcheon

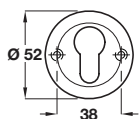

Euro profile cylinder escutcheon

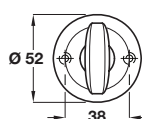

WC release and inside turn

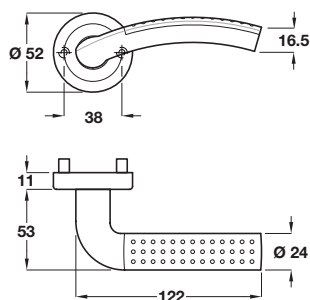
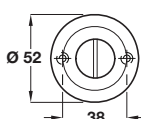

StarTec ANIKA lever handles

- Pair of lever handles and roses
- 8 mm spindle included
- Sprung, for use with standard duty followers
- Bolt through fixings included
- To suit doors **35-44 mm** thick
- Zinc alloy

Finish	Cat. No.
Matt nickel/polished chrome	900.20.982

Order qty: 1 pair

ANIKA accessories

- **Escutcheons:** Fixings included
- **WC release and inside turn:**
To suit doors **35-44 mm** thick
5 mm spindle and fixings included
- Zinc alloy

Finish	Matt nickel/Polished chrome
Standard keyway escutcheon	
Cat. No.	901.51.386
Euro profile escutcheon	
Cat. No.	901.52.386
WC release and inside turn	
Cat. No.	901.53.386*

Order qty: 1 pair (*set)

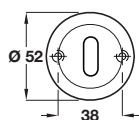

Standard keyway escutcheon

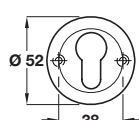

Euro profile cylinder escutcheon

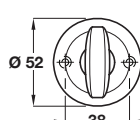

WC release and inside turn

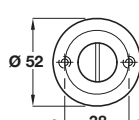

TCH 2013, © Häfele U.K. Ltd 2013. Dimensional data not binding. We reserve the right to alter specifications without notice.