

Please note there is a  $\pm 3$  mm tolerance on dimensions shown

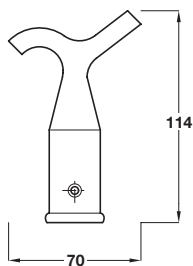

**Pole hook**

- To suit  $\varnothing$  25 mm pole (pole not supplied)
- Brass



Finish	Cat. No.
Polished brass	970.04.048
Polished chrome	970.04.042

Order qty: 1 pc

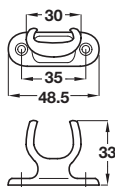

**Pole holder**

- To suit pole hook shown above
- Brass



Finish	Cat. No.
Polished chrome plated	979.00.612
Polished brass	979.00.618

Order qty: 1 pc

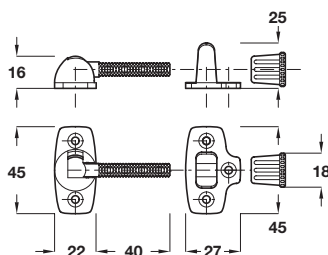

Please note there is a  $\pm 3$  mm tolerance on dimensions shown

**Economy sash fastener**

- Zinc alloy



Finish	Cat. No.
Electro brassed	970.04.008
Zinc-plated	970.04.009

Order qty: 1 pc

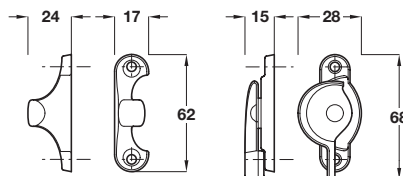

Please note there is a  $\pm 3$  mm tolerance on dimensions shown

**Economy sash fastener, fitch pattern**

- Zinc alloy



Finish	Cat. No.
Bright zinc-plated	970.04.019

Order qty: 1 pc

TCH 2013. © Häfele U.K. Ltd 2013. Dimensional data not binding. We reserve the right to alter specifications without notice.

5 Architectural Ironmongery: Window Fittings