

**Traditional sash pull handle**

- For face fixing
- Brass

Finish	Cat. No.
<b>102 mm length</b>	
Satin nickel	970.30.716
<b>152 mm length</b>	
Satin nickel	970.30.726



Order qty: 1 pc

**5**

Architectural Ironmongery: Window Fittings

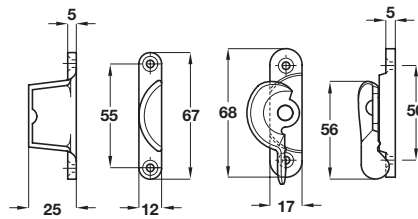

**Sash fastener, fitch pattern**

- Brass

Finish	Cat. No.
Satin chrome	970.02.924
Polished chrome	970.02.922
Polished brass	970.02.928



Order qty: 1 pc

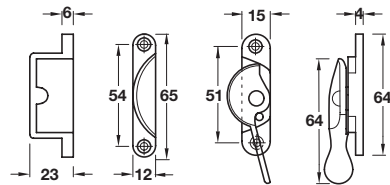

**Sash fastener, fitch pattern, lockable**

- Key not included, order **970.02.970** shown below separately
- Brass

Finish	Cat. No.
Satin chrome	970.02.934
Polished chrome	970.02.932
Polished brass	970.02.938
<b>Locking key</b>	970.02.970



Order qty: 1 pc

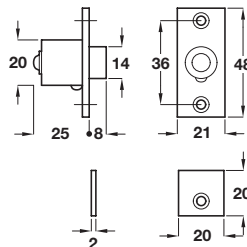

**Sash stop**

- Fixings included
- Order key separately **970.03.360** shown below
- Brass

Finish	Cat. No.
Satin nickel	970.03.356
Polished chrome	970.03.352
Polished brass	970.03.358



Order qty: 1 pc

**Sash stop key**

- To suit item sash stop shown above
- 125 mm long key, one key suits all
- Nickel plated brass

	Cat. No.
Sash stop key	970.03.360

Order qty: 1 pc

