

BS EN 1154

3	8	1-4	1	1	3
---	---	-----	---	---	---

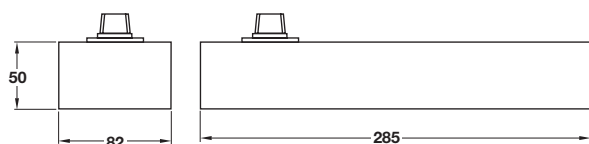
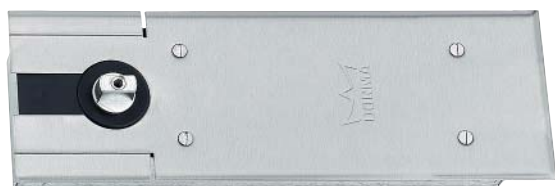

Dorma BTS 75V Floor spring

- Conforms to BS EN 1154
- Two versions; without hold-open function or with constant hold-open function for 90° door opening angle
- Suitable for DIN right and DIN left doors and for swing doors
- Closing force size 1-4
- Maximum door width 1100 mm
- Maximum door weight 120 kg
- Variably adjustable closing force and mechanical backcheck
- Closing speed depending on the angle (0° - 15° and 15° - 180°) are variably adjustable, independent from each other
- Self coloured cast aluminium
- **Order cover plate separately**, shown below

Function	Cat. No.
Without hold-open	932.00.000
Hold-open 90°	932.00.001

Order qty: 1 pc

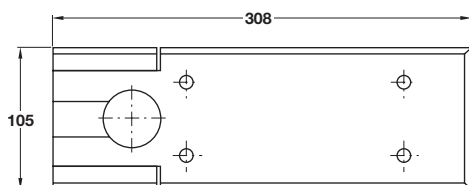

Dorma Floor spring cover plate

- To suit BTS 75 Floor spring shown above
- For swing doors as well as suitable for DIN left or DIN right hand by un-hooking the pre-stamped corner parts
- Stainless steel or brass

Finish	Cat. No.
Stainless steel	932.00.200

Order qty: 1 pc



PTP 26 Free swing floor pivot

- Ø 70 x 34 mm
- To suit floor spring shown left
- Maximum load capacity 100 kg
- Milled aluminium

	Cat. No.
Floor pivot	928.00.250

Order qty: 1 pc

5



Exclusive Handle Designs from Häfele

See Section 4

Architectural Ironmongery: Glass Door Fittings