

Assessed for use on fire doorsets with respect to BS EN 1634-1 and BS 476: part 22 - Report available on request.

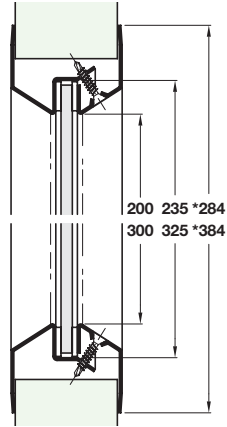

Circular metal porthole frame

- To suit 42-46 mm door thickness
- Fixing geometry ensures that the two self attaching rings pull together to sit flush to the door panel and allow for concealed fixings to one side
- Min. installation from edge of door should be no less than 125 mm
- Fits 6 and 6.4 mm glass at Ø 223 and Ø 323 mm
- *Please note:** there is a ±3 mm tolerance on dimensions
- Round glass to suit must be ordered separately, shown below
- Glazing tape and liners should be ordered separately,** shown on page 303

Door cut size	Ø 250 mm	Ø 350 mm
Clear vision size	Ø 200 mm	Ø 300 mm
Satin stainless steel	973.99.000	973.99.010

Order qty: 1 pc

Round glass

- To suit circular porthole frame shown above
- Available for fire and non-fire rated doors
- Fire resistant and non-fire rated frosted glass, as well as frosted glass with sex and toilet symbols, or company logos available to order, subject to quantity

Glass type	Glass thickness	Ø 223 mm	Ø 323 mm
Laminated clear safety (non-fire rated)			
Laminated	6.4 mm	973.99.200	973.99.210
Clear fire resistant (1/2 x 1hr fire rated)			
Clear	6 mm	973.99.203	973.99.213

Order qty: 1 pc

Square and rectangular glass

- To suit square metal vision frame shown above right
- Available for fire and non-fire rated doors
- 2 hour fire resistant 6 mm thick clear glass also available to order, subject to quantity
- Please note:** Glass sizes may vary +/- 3 mm

280 x 280 mm	432 x 432 mm	151 x 532 mm	151 x 735 mm
Laminated clear safety (non-fire rated) 6.4 mm glass thickness			
959.17.300	959.17.310	959.17.350	959.17.360
Clear fire resistant (1/2 x 1hr fire rated) 6 mm glass thickness			
959.17.303	959.17.313	959.17.353	959.17.363

Order qty: 1 pc

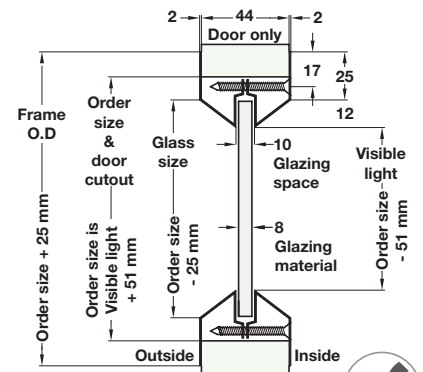
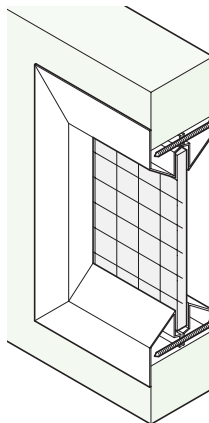
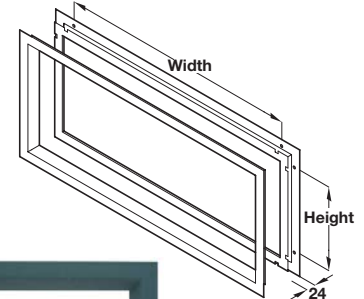
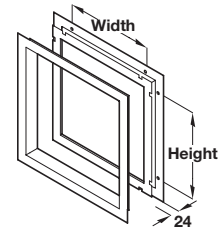
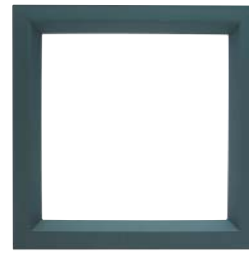

Low profile metal vision frame

- Flush to door look
- Uses 44 mm sheet metal screws that pass through the door cut-out, and fasten to the opposite side of the vision frame, thus eliminating the need to drill the door for through bolts and saving installation time and labour. It also leaves the corridor side of the frame free of fastenings, for added security and a cleaner, more aesthetic appearance
- To suit door thickness 42-46 mm
- Fire tested to 1 hour timber door, in conjunction with intumescent tapes and liners, shown on page 303
- Fits 6 and 6.4 mm glass
- Glass to suit must be ordered separately, shown below left
- Glazing tape and liners should be ordered separately, shown on page 303
- Brushed stainless steel, grade 304

Cut out size	305 x 305 mm	457 x 457 mm
Clear vision size	254 x 254 mm	406 x 406 mm
Standard square	959.17.000	959.17.010
Cut out size	178 x 559 mm	178 x 762 mm
Clear vision size	127 x 508 mm	127 x 711 mm
Standard rectangular	959.17.060	959.17.070

Order qty: 1 pc