



### Geze Floor spring cover plate

- Suits Geze floor springs TS 500 and 550 NV
- Corners adjacent to pivot may be removed for single action applications
- Stainless steel



Finish	Suits TS 500 NV	Suits TS 550 NV
Length x width	297 x 105 mm	362 x 105 mm
Satin stainless steel	932.10.130	932.10.110

Order qty: 1 pc



**Heavy duty**  
932.10.400

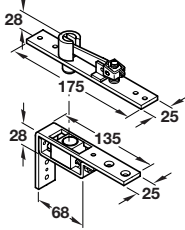

**Standard duty**  
932.10.410

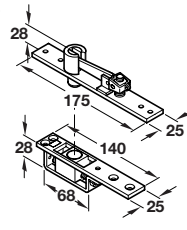

### Geze double action top centre

- To suit timber and metal doors
- Adjustable retractable upper pivot for double action doors
- Recommended minimum depth of head frame 50 mm
- Mild steel. Zinc plated



Version	Lateral adjustment	Cat. No.
Heavy duty	30-50 mm	932.10.400
Standard duty	36-58 mm	932.10.410

Order qty: 1 pc

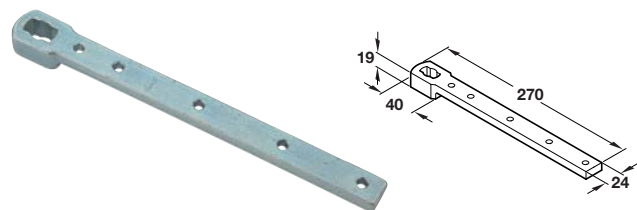

### Geze Double action bottom strap

- To suit timber and metal doors
- Drop forged steel, zinc plated



Cat. No.	932.10.270
----------	------------

Order qty: 1 pc

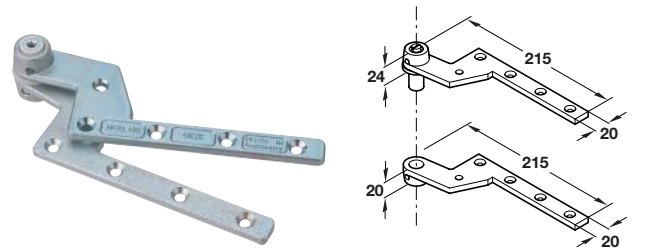

Order 1 pair cover caps separately

### Geze Single action top centre

- To suit timber and metal doors
- Unhanded
- Drop forged steel, zinc plated



Order 1 pair cover caps separately

Finish	Single action top centre
Zinc plated	932.10.420

Order qty: 1 pc

Finish	Cover cap
Aluminium, Satin stainless steel finish	932.10.520

Order qty: 1 pair

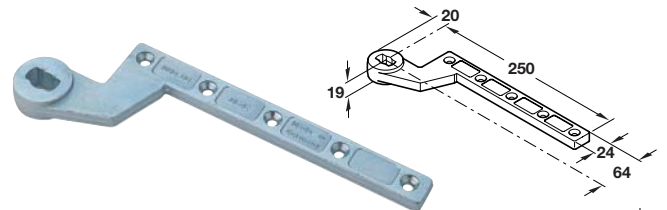

Order 1 left and 1 right cover cap separately (right hand version shown)

### Geze Single action bottom strap

- To suit timber and metal doors
- Unhanded
- Drop forged steel, zinc plated



Order 1 left and 1 right cover cap separately

Finish	Single action top centre
Zinc plated	932.10.200

Order qty: 1 pc

Cover cap		
Finish	Left hand	Right hand
Aluminium, satin stainless steel	932.10.510	932.10.500

Order qty: 1 pc

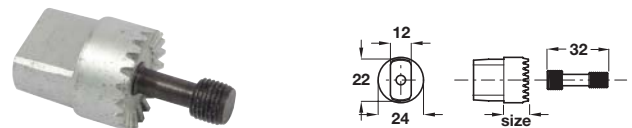

### Geze Extended interlock spindle

- To suit floor springs
- Fixing screw and extended flat cone included
- Hardened steel



Size	Cat. No.
10.1 mm	932.10.700
15.1 mm	932.10.703
20.1 mm	932.10.705
25.1 mm	932.10.706

Order qty: 1 pc