

BS EN 1154

3 8 2-4 1 1 4

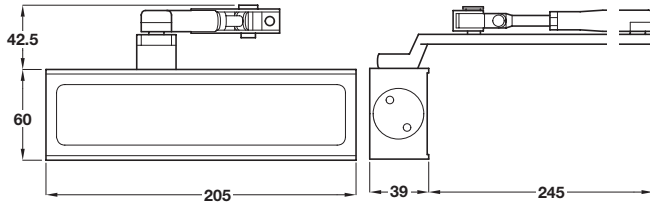
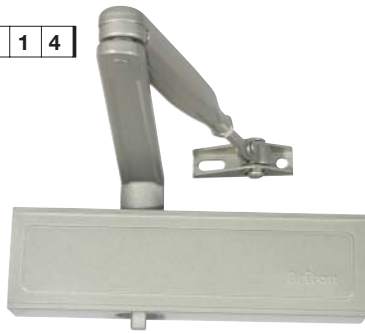

Briton 1110-SES overhead door closer

- Conforms to BS EN 1154, EN 1634
- Power size 2-4
- Max. door width 1100 mm
- Adjustable closing speed and latch action
- Fig 1, Fig 61 and Fig 66 application
- Cast aluminium body, mild steel arm



Finish	Cat. No.
Silver	931.60.609

Order qty: 1 pc

BS EN 1154

4 8 3 1 1 3

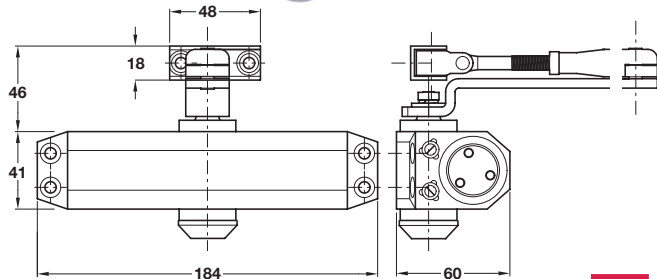

Briton 121CE overhead door closer

- Conforms to BS EN 1154: 1996/A1:2002
- Power size 3
- Max. door width 950 mm
- Adjustable closing speed and latch action
- Fig 1, Fig 61 and Fig 66 application
- Cast aluminium body, mild steel arm



Finish	Cat. No.
Silver	931.60.619

Order qty: 1 pc

BS EN 1154

4 8 3 1 1 3

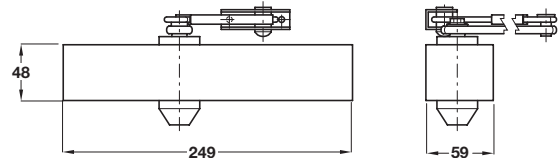

Briton 2003E overhead door closer

- Conforms to BS EN 1154: 1996/A1:2002
- Power size 3
- Max. door width 950 mm
- Adjustable closing speed and latch action
- Fig 1, Fig 61 and Fig 66 application
- Cast aluminium body, mild steel arm



Finish	Cat. No.
Silver powder coated	931.92.009

Order qty: 1 pc

Briton overhead door closers 1110-SES, 121CE and 2003E are universal fitting and suitable for Fig. 1, Fig 61 and Fig 66 application.

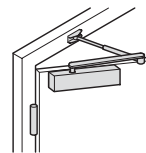

Fig 1 Standard application
(door leaf installation)
Closer is fixed to the pull side of the door

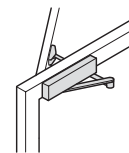

Fig 61 Transom application
(overhead installation)
Closer is fixed to the push side of the door

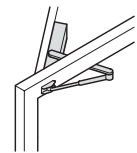

Fig 66 Parallel arm application:
Closer is fixed to the push side of the door using fixing bracket



A door stop should always be used for non backchecked doors, and where practical for backchecked doors, and at least 66% of the door width away from the hinge.

Door stops are shown on pages 283-286

TCH 2013. © Häfele U.K. Ltd 2013. Dimensional data not binding. We reserve the right to alter specifications without notice.