

Installation

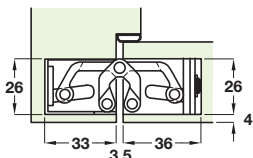

to wooden block frames

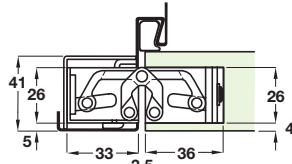

with receiver to steel frames

Tectus TE 525 3D hinge

- All stainless steel, ideal for areas where there may be hygiene, weathering or corrosion issues
- Maximum adjusted door weight 120 kg
- Opening angle 180°
- 3-way continuous adjustment
Vertical: ± 3 mm
Horizontal: ± 3 mm
Depth: ± 1 mm
- For wooden, steel or aluminium frames, for flush doors
- For min. door thickness 40 mm
- Suitable for left and right hand applications
- Maintenance-free friction bearings
- Fixing screws included for frame and door part
- Stainless steel



Finish	Cat. No.
Satin stainless steel	924.16.403

Order qty: Multiples of 2 pcs

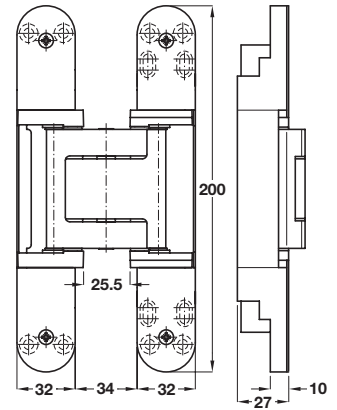

Installation

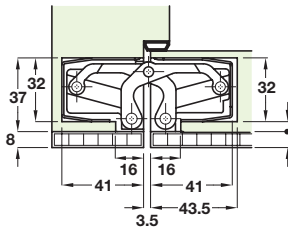

to wooden block frames

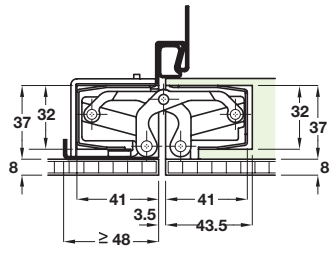

with receiver to steel frames

Tectus TE 540 3D A8 hinge

- Maximum adjusted door weight 100 kg
- Opening angle 180°
- 3-way continuous adjustment
Vertical: ± 3 mm
Horizontal: ± 3 mm
Depth: ± 1 mm
- For wooden, steel or aluminium frames, for flush doors
- For min. door thickness 40 mm (min. 44 mm with intelligent kit)
- Suitable for left and right hand applications
- Maintenance free friction bearings
- Fixing screws included for frame and for door part
- Aluminium, zinc diecast and steel



Finish	Cat. No.
Matt nickel (f2) powder coated	924.17.322
Satin stainless steel effect	924.17.304

Order qty: Multiples of 2 pcs

Door and frame template set for Tectus TE 540 3D A8 hinge

- For routing the hinge recess for TECTUS TE 540 3D A8
- Aluminium

Suitable for	Set includes templates	Cat. No.
TECTUS TE 540 3D A8	for steps 1, 2 and 3	924.17.627

Order qty: 1 set