

Fittings for Sliding Folding Interior Doors

Foldaside 340 Endfold

Foldaside butt hinges for extra heavy duty usage, door thickness **44 mm+**:

A Brass DPBW butt hinge

- 102 x 76 mm
- Phosphor bronze washers with brass pin
- Polished brass

Max. adj. door weight	60 kg
Polished brass	921.08.042

Order qty: 1 pc

B Stainless steel butt hinge

- 102 x 76 mm
- Thrust bearing washers to each joint
- Satin or polished stainless steel or electrophoretic brass-plated stainless steel

BS EN 1935 grade 13	Cat. No.
Satin stainless steel	921.08.140
Polished stainless steel	926.91.041
Brass-plated	921.08.159

Order qty: 1 pc

C Stainless steel butt hinge

- 102 x 76 mm. Drilled ANSI pattern. Two high quality ball bearing race joints. Stainless steel

	Cat. No.
Satin stainless steel	926.92.100
Polished stainless steel	921.08.621

Order qty: Multiples of 2 pcs

D Twin ball catch

- To act as holdback catch on access door or to prevent door panel drift. Tension adjustable with a screw-driver. Solid chrome steel balls. Brass catch and counterpiece

Finish	Cat. No.
Bright brass	244.20.017
Nickel-plated	244.20.639

Order qty: 1 pc

E Cabin hooks

- Alternative to twin ball catch. Fixing screws included. Brass

Finish	Cat. No.
Polished brass	938.13.008
Satin chrome	938.13.004
Polished chrome	938.13.002

Order qty: 1 pc

F Lever action flush bolt

- For folding doors. Door thickness 45 mm+. Zinc die cast mazak alloy

Finish	Cat. No.
Pol. brass, lacquered	900.17.815
Satin nickel-plated	900.17.806

Order qty: 1 pc

G Flush handle

Normal usage. Fixing screws included. Brass

Finish	Cat. No.
Satin nickel-plated	910.37.044
Polished brass	910.37.035

Order qty: 1 pc

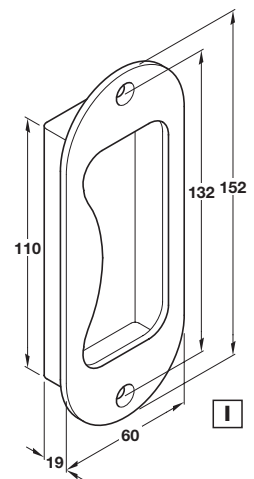
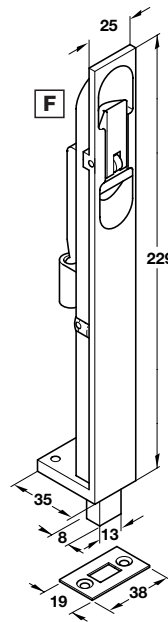
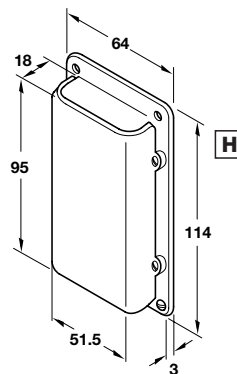
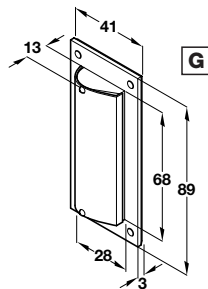
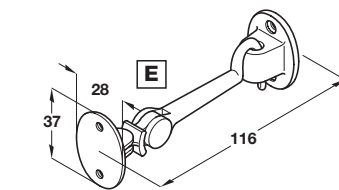
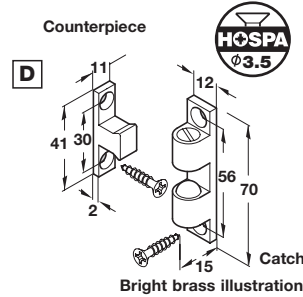
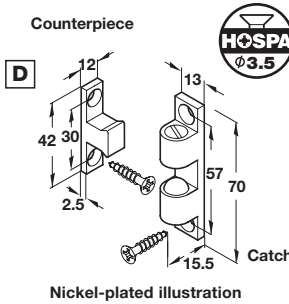
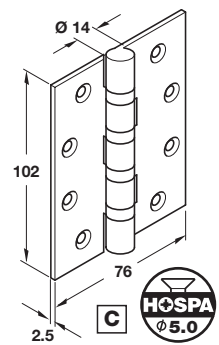
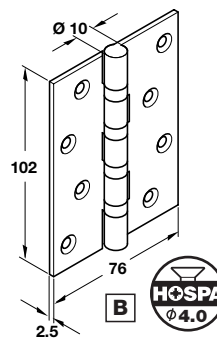
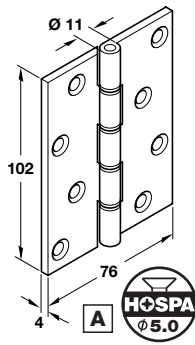

H Flush handle

Heavy duty usage. Normally used where door thickness is 50 mm or more. Fixing screws included. Brass

Finish	Cat. No.
Satin nickel-plated	910.37.062
Polished brass	910.37.071

Order qty: 1 pc

I Flush handle

- Normally used where door thickness is 50 mm or more. Fixing screws included. Stainless steel

Finish	Cat. No.
Satin	902.04.320
Polished	902.04.321

Order qty: 1 pc