

### A TouchClean™ Doc 'M' pack

- Available in 2 colours: white or blue (RAL 5011)
- Available in 2 variations: low level or close coupled
- **Low level** version consists of:
  - 1 x Drop down grab rail
  - 5 x 600 mm grab rails
  - 1 x Cushioned back rest rail
- **Close coupled** version consists of:
  - 1 x Drop down grab rail
  - 5 x 600 mm grab rails
- Plastic coated steel
- For dimensional drawings, please see page 43

Finish	Low level	Close coupled
White	● <del>980.39.107</del>	● <del>980.39.117</del>
Blue RAL 5011	● <del>980.39.108</del>	● <del>980.39.118</del>

Order qty: 1 set

**Discontinued** ●  
**Discontinued when stock = 0** +

**Discontinued**  
980.39.107 - No longer available  
980.39.108 - No longer available  
980.39.117 - No longer available  
980.39.118 - No longer available



Note: Sanitary ware i.e. sink and toilet are not included

**Discontinued**  
982.03.000 - No longer available  
982.03.001 - No longer available  
982.03.002 - No longer available

### B TouchClean™ handrail bracket

- Conforms to DDA requirements
- Stainless steel, grade 316 or aluminium

Finish	Cat. No.
Satin stainless steel	● <del>982.03.000</del>
Polished stainless steel	● <del>982.03.001</del>
Polished anodised aluminium	● <del>982.03.002</del>

Order qty: 1 pc

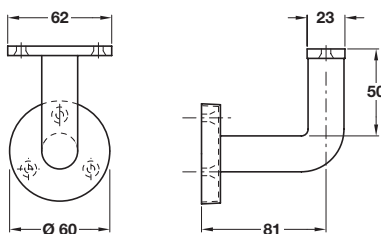

**Item A.**  
Photo amended and text removed  
Allen key is NOT included

### C TouchClean™ toilet roll holder

- Wooden roller
- Stainless steel, grade 316 or aluminium

Finish	Cat. No.
Polished anodised aluminium	● <del>980.39.202</del>

Order qty: 1

**Discontinued**  
980.39.202 - No longer available

**Item A.**  
Catalogue shows 74 mm  
Correct dimension is 81 mm

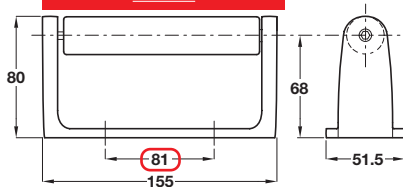

**Discontinued**  
903.01.760 - No longer available  
903.01.761 - No longer available  
905.02.791 - No longer available  
903.01.770 - No longer available  
903.01.771 - No longer available  
905.02.801 - No longer available

### D TouchClean™ 'Hospital pull handle'

- Vertical pull handle with special canted lower portion to assist the less able
- Available bolt through or back to back
- Stainless steel, grade 316 or aluminium

Finish	Bolt through	Back to back
Satin stainless steel	● <del>903.01.760</del>	● <del>903.01.770</del>
Pol. stainless steel	● <del>903.01.761</del>	● <del>903.01.771</del>
Pol. anodised aluminium	● <del>905.02.791</del>	● <del>905.02.801</del>

Order qty: 1 pc (Back to back = 1 pair)

