

Other door thicknesses are available to order, subject to quantity.



Satin anodised aluminium finish

A Letter plate assembly

- To suit fire, smoke and acoustic applications
- 30 minute fire rated
- Certifire approved, certificate no. CF255
- Achieves 31Db/Rw sound reduction
- Aperture size **250 x 40 mm**
- All letter plates include internal flap, intumescent liner and smoke seals
- To suit door thicknesses **42-47 mm** or **52-57 mm**
- Fixing bolts included
- Aluminium
- Note:** Internal security catch must be ordered separately, shown on page 159

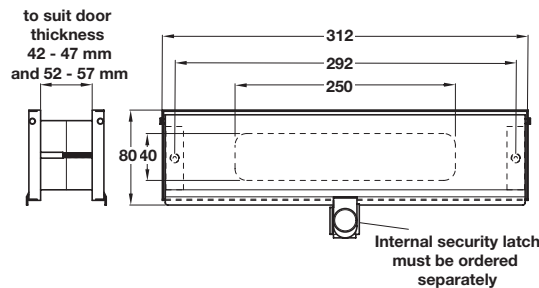

Finish	Cat. No.
Door thickness 42-47 mm	
Satin anodised aluminium	986.07.239
Gold anodised aluminium	986.07.238
Door thickness 52-57 mm	
Satin anodised aluminium	986.07.249
Gold anodised aluminium	986.07.248

Order qty: 1 pc

Satin anodised aluminium finish



B Letter plate assembly

- To suit fire and smoke
- 30 minute fire rated
- Certifire approved, certificate no. CF255
- Aperture size **250 x 40 mm**
- All letter plates include internal flap and intumescent aperture liner
- To suit door thickness **42-47 mm**
- Fixing bolts included
- Aluminium
- Note:** Internal security catch must be ordered separately, shown on page 159

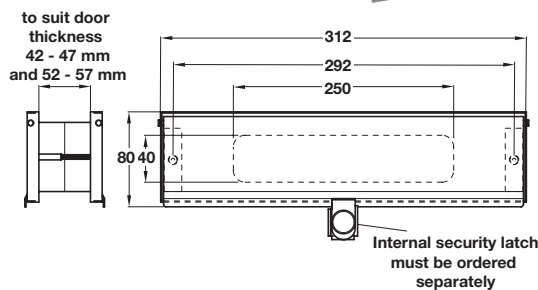

Finish	Cat. No.
Door thickness 42-47 mm	
Satin anodised aluminium	986.07.209
Gold anodised aluminium	986.07.208

Order qty: 1 pc

Satin anodised aluminium finish



C Letter plate assembly

- To suit non-fire rated doors
- Aperture size **270 x 60 mm**
- All letter plates include internal flap and aperture liner
- To suit door thickness **42-47 mm**
- Fixing bolts included
- Aluminium
- Note:** Internal security catch must be ordered separately, shown on page 159

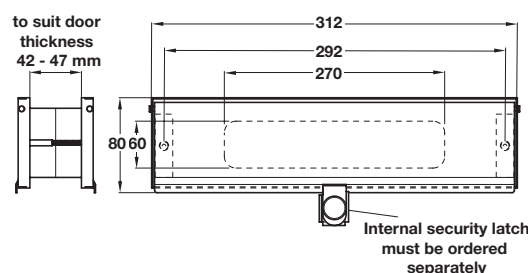

Finish	Cat. No.
Door thickness 42-47 mm	
Satin anodised aluminium	986.07.149
Gold anodised aluminium	986.07.148

Order qty: 1 pc

TCH-A1 2008, HUK. Dimensional data not binding. We reserve the right to alter specifications without notice.