

Stainless Steel Butt Hinges HI-LOAD Range

These hinges have obtained Certifire approval.
Maintenance free, 25 year performance guarantee.
All fixings for timber included.

Also available in mild steel - refer to page 40

Refer to pages 2-3 for information on BS EN 1935, hinge grades and classification.

HI-LOAD hinges product guide: page 17

A Stainless steel hinge, 3 knuckle, fixed pin

- Grade **13** BS EN 1935
- Maximum adjusted door weight **120 kg**
- Minimum door thickness **44 mm**
- Square and radius corners
- Maintenance free
- **25** year performance guarantee
- Certifire CF209 approved for fire doors up to 1 hour
- Ø 5 x 30 mm wood screws included
- Grade 304 stainless steel

Length x width	100 x 88 mm	
Finish	Satin	Polished
Square corners	926.88.000	926.88.001
Radius corners	926.88.230	926.88.231

Order qty: 1 pc

Intumescent pads

Cat. No.	950.08.413
----------	------------

Order qty: **1 set** (sufficient for 25 hinges)

BS EN 1935

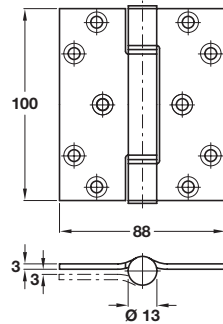
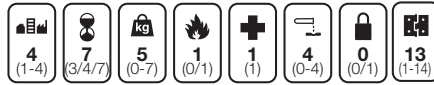

Note: Also available in Grade 316 stainless steel subject to quantity

RT



Satin stainless steel finish shown
Square corners

B Stainless steel hinge, 3 knuckle, fixed pin

- Grade **12** BS EN 1935
- Maximum adjusted door weight **100 kg**
- Minimum door thickness **40 mm**
- Square and radius corners
- Maintenance free
- **25** year performance guarantee
- Certifire CF209 approved for fire doors up to 1 hour
- Ø 5 x 30 mm wood screws included
- Grade 304 stainless steel

Length x width	100 x 86 mm	
Finish	Satin	Polished
Square corners	926.88.010	926.88.011
Radius corners	926.88.240	926.88.241

Order qty: 1 pc

Intumescent pads

Cat. No.	950.08.413
----------	------------

Order qty: **1 set** (sufficient for 25 hinges)

BS EN 1935

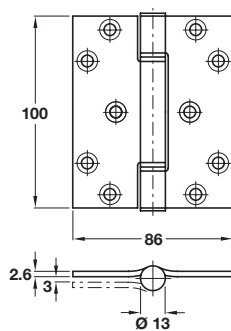

RT



Satin stainless steel finish shown
Square corners

Items A & B.
Catalogue shows...
'multiples of 25 pcs'
Correct order qty is **'1 set'**

C Stainless steel hinge, 3 knuckle, fixed pin

- Grade **11** BS EN 1935
- Maximum adjusted door weight **80 kg**
- Minimum door thickness **35 mm**
- Square and radius corners
- Maintenance free
- **25** year performance guarantee
- Certifire CF209 approved for fire doors up to 1 hour
- Ø 4 x 30 mm wood screws included
- Grade 304 stainless steel

Length x width	100 x 75 mm	
Finish	Satin	Polished
Square corners	926.88.110	926.88.111
Radius corners	926.88.250	926.88.251

Order qty: 1 pc

BS EN 1935

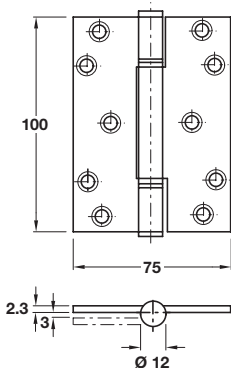

RT



Satin stainless steel finish shown
Square corners

TCH-A1 2008, HUK. Dimensional data not binding. We reserve the right to alter specifications without notice.

11.06.09/1*