

1

Compatibility rating



For full explanation see page 2

Satin stainless steel finish

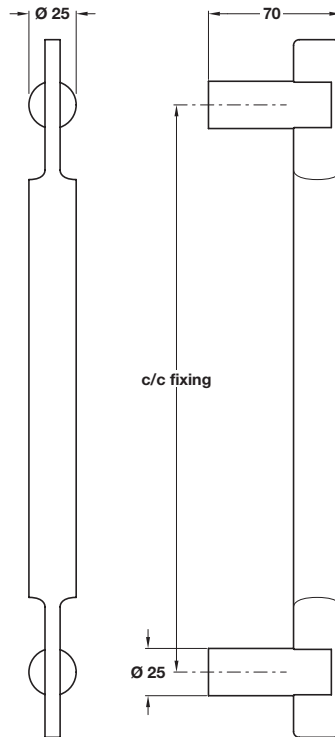

A ANNAPURNA pull handle

- Single pull handle
- Bolt through fixing
- M8 through fixing bolts included
- To suit doors up to **54 mm** thick
- 316 stainless steel

c/c fixing	300 mm	450 mm
Satin stainless steel	903.00.180	903.00.190
Polished stainless steel	903.00.181	903.00.191

Order qty: 1 pc

Example: Bolt through fixing



B ANNAPURNA pull handle

- Pair of pull handles
- Back to back fixing
- M8 through fixing bolts included
- To suit doors up to **54 mm** thick
- 316 stainless steel

c/c fixing	300 mm	450 mm
Satin stainless steel	903.00.200	903.00.210
Polished stainless steel	903.00.201	903.00.211

Order qty: 1 pair

Example: Back to back fixing

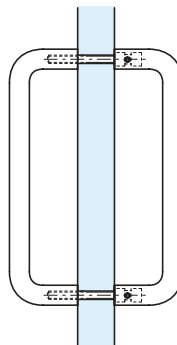

C Glass door fixing set

- To convert item **B** to glass door fixing
- Pair of nylon sheaths
- 4 x **Ø 25 mm** nylon washers
- Special M8 fixing bolts included
- To suit doors **8-18 mm** thick
- Ø 13 mm holes required

Cat. No.	909.00.915
----------	------------

Order qty: 1 set

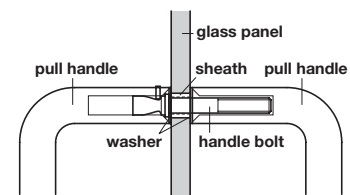
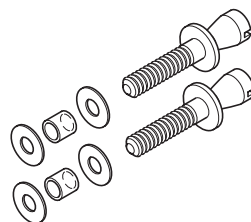

TCH-A1 2008, HUK. Dimensional data not binding. We reserve the right to alter specifications without notice.