

Steel Butt Hinges Cranked, Flush

Regular lubrication required, unless marked 'maintenance free'.
Fixings are not included.

Important: The logo shown indicates the type and size of screw required, which must be ordered separately



Refer to pages 2-3 for information on BS EN 1935, hinge grades and classification

A Cranked flush hinge

- For medium duty applications
- Normally for 10 mm door thicknesses
With fixed pin
- Non mortise
- Steel

Finish	Cat. No.
Electro brassed	351.96.520

Order qty: 1 pair

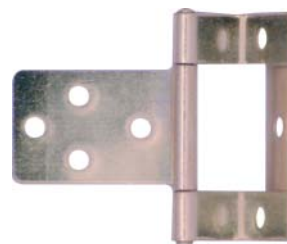
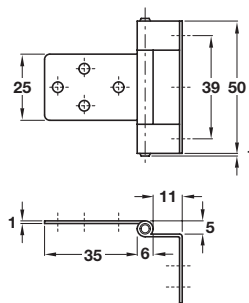

3