

- **Application:** Heavy duty top hung cupboard door fitting with robust concealed bottom control
- **Range:** Max. door weight **40/75 kg**
Door thickness **19 to 22 mm**
- **Tracks and channels are not included in the fitting sets and must be ordered separately**
- **Each fitting set comes complete with fitting instructions**

For ancillary door hardware i.e. locks, handles and bolts etc see page 57

A Double top track

Pre-drilled for mounting screws. Silver anodised aluminium

Length	2.5 m	3.5 m
Cat. No.	406.51.116	406.51.125

Order qty: Multiples of 2.5 or 3.5 metres

B Double bottom guide channel

Pre-drilled for mounting screws. Silver anodised aluminium

Length	2.5 m	3.5 m
Cat. No.	406.72.919	406.72.928

Order qty: 1 pc (2.5 or 3.5 m length)

Rotula Mixfront fitting sets

C Trolley hanger, for outer door, vertically adjustable up to **10 mm**, with anti-jump device. Ball-bearing mounted concave plastic rollers and 2 integral locating lugs in mounting plate. Galvanized steel

- With 1 roller, for door weights up to **40 kg**
- With 2 rollers, for door weights up to **75 kg**

D Trolley hanger, for inner door as above but with provision for installation of follower **E**. Galvanized steel

- With 1 roller, for door weights up to **40 kg**
- With 2 rollers, for door weights up to **75 kg**

E Follower, for screw mounting on running gear **D** (only one follower per door required), with rubber buffer and M5 x 6 mm fastening screw. Galvanized steel

F Track stopper, for inner and outer door for adjustable mounting in top track. Two part, with plastic spring clip reversible from right to left (must be inserted into the track before installation). Galvanized steel

G Track stopper, for outer door (3-door layouts only) with steel spring. Adjustable mounting in top track. Can be used left or right (must be inserted into the track before the spring is installed). Corrosion resistant steel

H Allen key, to secure stoppers **F** and **G** in top track

I Guide, for outer door. Mounting plate with locating lug and nylon roller guide. Galvanized steel

J Guide, for inner door. Mounting plate with roller guide. Galvanized steel

K Guide track stopper. For installation in bottom guide channel. Adjustable. Bright aluminium

L Rubber buffer, for installation in edge of door. White rubber

Fitting sets	for 2 doors	for 3 doors
C Trolley hanger, outer	2 pcs	2 pcs
D Trolley hanger, inner	2 pcs	4 pcs
E Follower	1 pc	2 pcs
F Track stopper, inner	2 pcs	2 pcs
G Track stopper, outer	-	1 pc
H Allen key	1 pc	1 pc
I Guide, outer	2 pcs	2 pcs
J Guide, inner	2 pcs	4 pcs
K Guide track stopper	2 pcs	3 pcs
L Rubber buffer	-	2 pcs
Max. door weight	Cat. No.	
40 kg	406.50.049	406.50.059
75 kg	406.50.149	406.50.159

Order qty: 1 set (order 1 set per 2 or 3 door application)

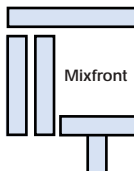

Top track surface mounted
Guide channel surface mounted
With screw fixing running gear

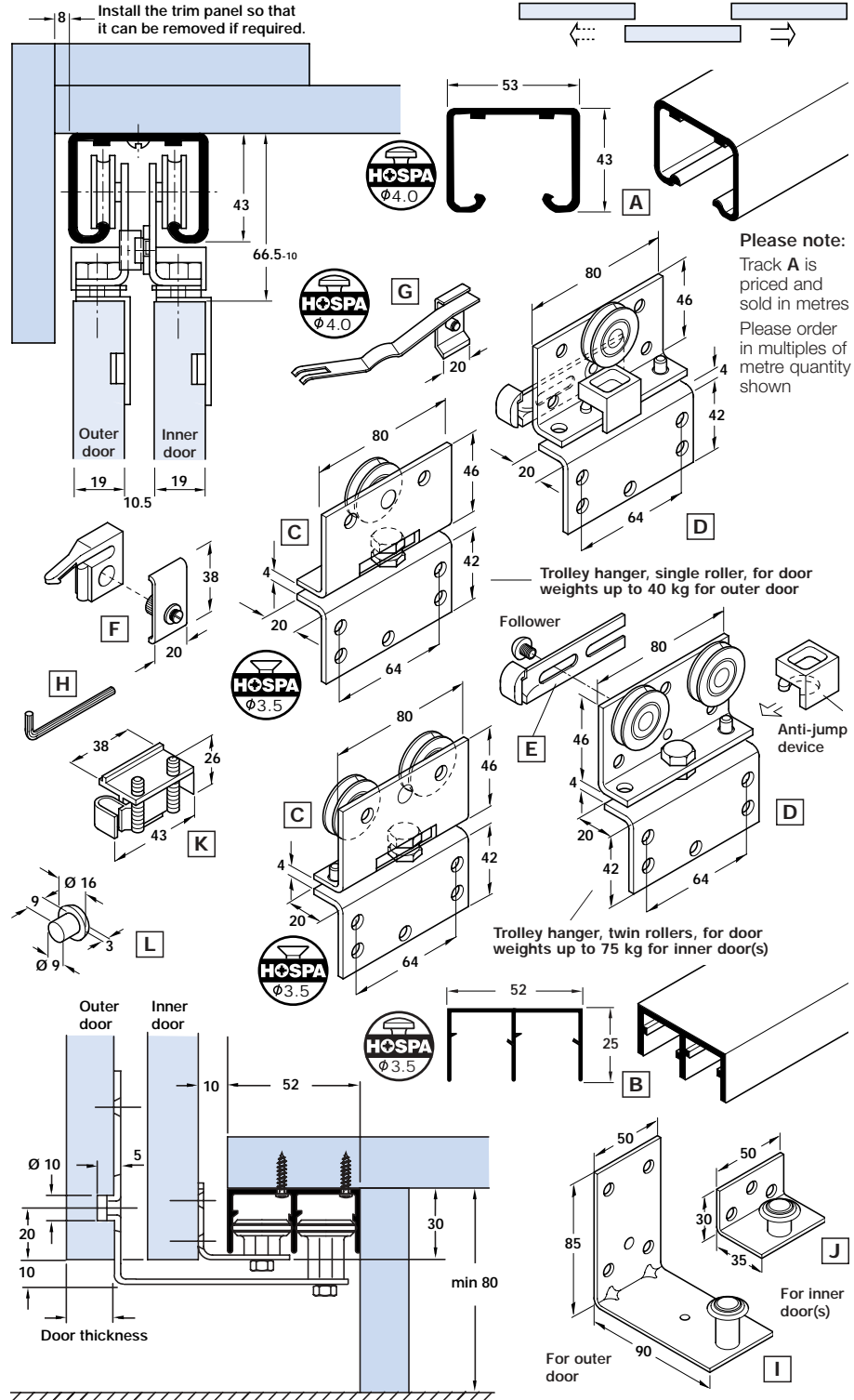

Please note:
Track A is priced and sold in metres
Please order in multiples of metre quantity shown

Trolley hanger, single roller, for door weights up to 40 kg for outer door

Trolley hanger, twin rollers, for door weights up to 75 kg for inner door(s)

For inner door(s)

For outer door